

CLERK'S OFFICE  
**AMENDED AND APPROVED**  
Date: 12-17-03

Submitted by: Chair of the Assembly  
at the Request of the Mayor  
Prepared by: Project Management  
& Engineering Department  
For Reading: November 18, 2003

ANCHORAGE, ALASKA  
AR NO. 2003- 356

1 A RESOLUTION CONFIRMING AND LEVYING SPECIAL ASSESSMENTS FOR  
2 SPECIAL ASSESSMENT DISTRICT NO. 3P99, WHICH PROVIDED ALLEY PAVING  
3 IMPROVEMENTS ON THE I STREET/K STREET ALLEY BETWEEN 15<sup>TH</sup> AVENUE  
4 AND 16<sup>TH</sup> AVENUE, AND SETTING THE DATE OF ASSESSMENT INSTALLMENT  
5 PAYMENTS, INTEREST ON UNPAID ASSESSMENTS, AND PROVIDING FOR  
6 PENALTIES AND INTEREST IN THE EVENT OF DELINQUENCY  
7

8  
9 THE ANCHORAGE ASSEMBLY RESOLVES:  
10

11 Section 1. The improvements authorized in Anchorage Ordinance 99-  
12 93 have been completed and actual costs determined. Special assessments are hereby  
13 levied against properties benefited by said improvements as set forth in the attached  
14 assessment roll prepared for the district.  
15

16 Section 2. Timely notice of assessment was sent to each property  
17 owner whose property is benefited by the improvements as indicated on the attached  
18 assessment roll. Each property owner was also given notice of a Public Hearing to be  
19 held before the Municipal Assembly. This provided property owners an opportunity to  
20 present objections and/or inequalities in the assessment roll for the district.  
21

22 Section 3. In conformance with the notice to the property owners, the  
23 Assembly held a Public Hearing on December 17, 2003. At said hearing, all errors  
24 and inequalities to which valid objections were raised were corrected. The amounts  
25 indicated on the assessment roll are those amounts determined to be assessed. Said  
26 amounts are equal to, or less than, the benefit each property derives from the  
27 constructed improvements. The assessment roll has been duly certified by the  
28 Municipal Clerk.  
29

30 Section 4. All assessments and installment interest thereon may be  
31 paid in approximately equal annual installments, according to the schedule specified in  
32 Assembly Resolution No. 93-179. Annual installments are due and payable on or  
33 before the 28th day of February of each year, with the first such installment  
34 coming due and being payable on February 28, 2004.  
35

36 Section 5. Interest on the unpaid assessment shall be at the rate equal  
37 to the effective interest rate on the last bonds sold to finance similar improvements.



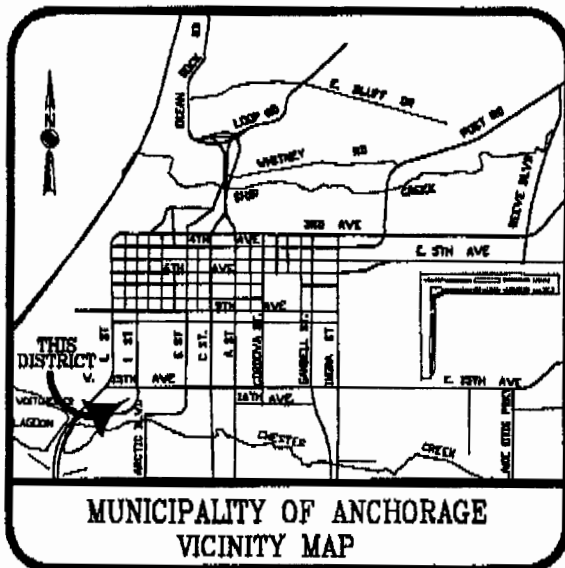
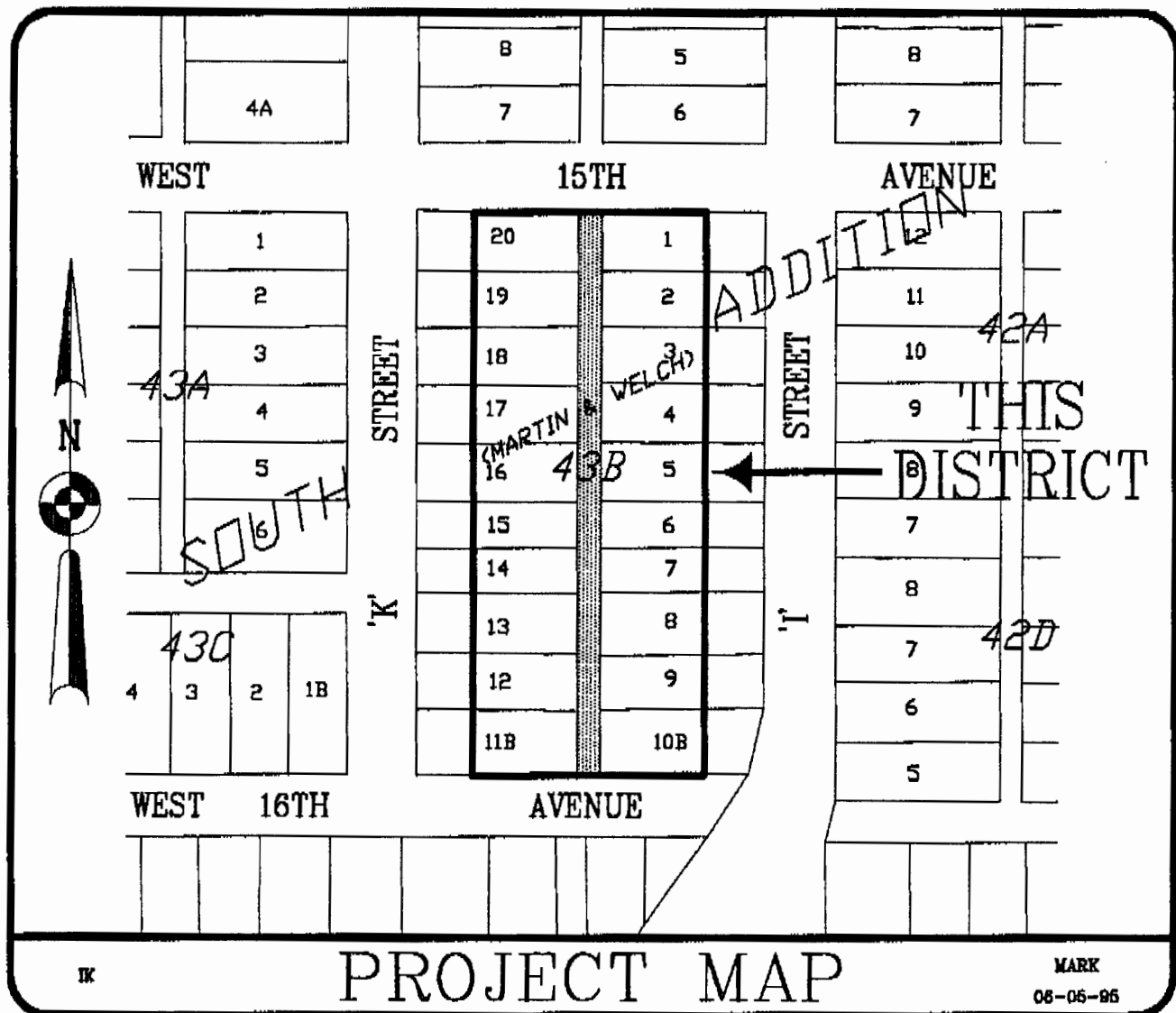

## ASSESSMENT DISTRICT

## ALLEY PAVING

'I'-'K' STREET ALLEY

WEST 15TH AVE TO WEST 16TH AVE

DEPARTMENT OF PUBLIC WORKS  
OFFICE OF THE MUNICIPAL ENGINEER

# Final Assessment Roll for Special Assessment District 3P99: I St/K St Alley Paving RID - 15th Ave to 16th Ave

ID	TAXID	SUBDIVISION	BLOCK	LOT	PERCENT SHARE	TOTAL ASSESSMENT	YEARS TO PAY	ANNUAL ASSESSMENT	COLLECTION CHARGE	ANNUAL PAYMENT	INTEREST AT 4.57%	PRINCIPAL & INTEREST PAID
1	00109207	MARTIN AND WELCH SUBD OF THE (SOUTH ADDITION)	43B	1	5.13%	\$2,312.19	5	\$527.72	\$42.00	\$569.72	\$326.44	\$2,638.62
2	00109208	MARTIN AND WELCH SUBD OF THE (SOUTH ADDITION)	43B	2	5.13%	\$2,312.19	5	\$527.72	\$42.00	\$569.72	\$326.44	\$2,638.62
3	00109209	MARTIN AND WELCH SUBD OF THE (SOUTH ADDITION)	43B	3	5.13%	\$2,312.19	5	\$527.72	\$42.00	\$569.72	\$326.44	\$2,638.62
4	00109210	MARTIN AND WELCH SUBD OF THE (SOUTH ADDITION)	43B	4	5.13%	\$2,312.19	5	\$527.72	\$42.00	\$569.72	\$326.44	\$2,638.62
5	00109211	MARTIN AND WELCH SUBD OF THE (SOUTH ADDITION)	43B	5	5.13%	\$2,312.19	5	\$527.72	\$42.00	\$569.72	\$326.44	\$2,638.62
6	00109212	MARTIN AND WELCH SUBD OF THE (SOUTH ADDITION)	43B	6	4.10%	\$1,849.75	5	\$422.18	\$42.00	\$464.18	\$261.15	\$2,110.90
7	00109213	MARTIN AND WELCH SUBD OF THE (SOUTH ADDITION)	43B	7	4.10%	\$1,849.75	5	\$422.18	\$42.00	\$464.18	\$261.15	\$2,110.90
8	00109214	MARTIN AND WELCH SUBD OF THE (SOUTH ADDITION)	43B	8	5.13%	\$2,312.19	5	\$527.72	\$42.00	\$569.72	\$326.44	\$2,638.62
9	00109215	MARTIN AND WELCH SUBD OF THE (SOUTH ADDITION)	43B	9	5.13%	\$2,312.19	5	\$527.72	\$42.00	\$569.72	\$326.44	\$2,638.62
10	00109216	MARTIN AND WELCH SUBD OF THE (SOUTH ADDITION)	43B	10B	0.00%	\$0.00	10	\$337.98	\$42.00	\$379.98	\$714.65	\$3,379.83
11	00109217	MARTIN AND WELCH SUBD OF THE (SOUTH ADDITION)	43B	11B	5.91%	\$2,665.18	10	\$337.98	\$42.00	\$379.98	\$714.65	\$3,379.83
12	00109218	MARTIN AND WELCH SUBD OF THE (SOUTH ADDITION)	43B	12	5.13%	\$2,312.19	5	\$527.72	\$42.00	\$569.72	\$326.44	\$2,638.62
13	00109219	MARTIN AND WELCH SUBD OF THE (SOUTH ADDITION)	43B	13	5.13%	\$2,312.19	5	\$527.72	\$42.00	\$569.72	\$326.44	\$2,638.62
14	00109220	MARTIN AND WELCH SUBD OF THE (SOUTH ADDITION)	43B	14	4.10%	\$1,849.75	5	\$422.18	\$42.00	\$464.18	\$261.15	\$2,110.90
15	00109221	MARTIN AND WELCH SUBD OF THE (SOUTH ADDITION)	43B	15	4.10%	\$1,849.75	5	\$422.18	\$42.00	\$464.18	\$261.15	\$2,110.90
16	00109222	MARTIN AND WELCH SUBD OF THE (SOUTH ADDITION)	43B	16	5.13%	\$2,312.19	5	\$527.72	\$42.00	\$569.72	\$326.44	\$2,638.62
17	00109223	MARTIN AND WELCH SUBD OF THE (SOUTH ADDITION)	43B	17	5.13%	\$2,312.19	5	\$527.72	\$42.00	\$569.72	\$326.44	\$2,638.62
18	00109224	MARTIN AND WELCH SUBD OF THE (SOUTH ADDITION)	43B	18	5.13%	\$2,312.19	5	\$527.72	\$42.00	\$569.72	\$326.44	\$2,638.62
19	00109225	MARTIN AND WELCH SUBD OF THE (SOUTH ADDITION)	43B	19	5.13%	\$2,312.19	5	\$527.72	\$42.00	\$569.72	\$326.44	\$2,638.62
20	00109226	MARTIN AND WELCH SUBD OF THE (SOUTH ADDITION)	43B	20	5.13%	\$2,312.19	5	\$527.72	\$42.00	\$569.72	\$326.44	\$2,638.62
		Municipal contribution to parcel 00109216			5.91%	\$2,665.18						
					100.00%	\$45,100.00						

After Recording, return to:  
Project Management Engineering  
Municipality of Anchorage  
P.O. Box 196650  
Anchorage, Alaska 99519



# MUNICIPALITY OF ANCHORAGE

## ASSEMBLY MEMORANDUM

No. AM 873-2003

**Meeting Date:** November 18, 2003

**FROM:** Mayor

**SUBJECT:** Resolution Confirming and Levying Special Assessments for Special Assessment District 3P99 which provided alley paving improvements on the I Street/K Street alley between 15<sup>th</sup> Avenue and 16<sup>th</sup> Avenue

On July 13, 1999, the Municipal Assembly approved Ordinance No. AO 99-93 creating special assessment district 3P99 for alley paving improvements on the I Street/K Street alley between 15<sup>th</sup> Avenue and 16<sup>th</sup> Avenue. Original project cost was estimated at \$60,000. Project construction is complete and the actual project cost is \$103,414.74. Most of the cost increase was related to added concrete retaining walls and underestimated design and construction survey costs.

AO No. 99-93 specified that assessments would be the lesser amount of: (1) construction contract costs plus twenty percent (20%) for non-contract costs, plus actual acquisition costs; or (2) the last approved estimate plus ten percent (10%). The second option is the lowest at \$45,100, which is 10% higher than the estimated assessable cost of \$41,000 approved by property owners in the petition. This total assessable amount was used in calculating final assessments for each parcel, which are in turn 10% higher than those approved by property owners.

Information on the proposed final assessments was provided in a letter to property owners and at a public meeting. The property owners of Lot 10B, Block 43 B of the Martin Welch Subdivision of the South Addition requested that their assessment be waived as they have never used the alley and a retaining wall constructed along the alley prohibits alley access. We concur with their request and the final assessment roll eliminates their assessment.

Passage of this resolution will have no fiscal impact on any Municipal property.

THE ADMINISTRATION RECOMMENDS A PUBLIC HEARING BE SCHEDULED FOR THIS RESOLUTION AND, UPON CONCLUSION OF THE HEARING, APPROVE THE RESOLUTION AND SET THE DATE OF FIRST PAYMENT.

Prepared by: Howard C. Holtan, Director, Project Management & Engineering Department  
Concur: Denis C. LeBlanc, Municipal Manager  
Respectfully submitted: Mark Begich, Mayor

### Content Information

**Content ID :** 001238

**Title:** Resolution Confirming and Levying Special Assessments for Special Assessment District 3P99 which provided alley paving improvements on the I St.-K St. alley between 15th Ave. and 16th Ave.

**Author:** schuringmj

**Initiating Dept:** PME

**Description:** Resolution Confirming and Levying Special Assessments for Special Assessment District 3P99 which provided alley paving improvements on the I St.-K St. alley between 15th Ave. and 16th Ave.

**Keywords:** I St., K St., Special Assessments, 3P99, alley

**Date Prepared:** 10/28/03 10:04 AM

### Workflow History

<u>Workflow Name</u>	<u>Action Date</u>	<u>Action</u>	<u>User</u>	<u>Security Group</u>	<u>Content ID</u>
AllOtherARWorkflow	10/28/03 10:07 AM	Checkin	schuringmj	Public	001238
PME_SubWorkflow	10/28/03 10:08 AM	Approve	holtanhc	Public	001238
MuniManager_SubWorkflow	11/10/03 8:17 AM	Approve	leblancdc	Public	001238
MuniMgrCoord_SubWorkflow	11/10/03 11:33 AM	Approve	katkusja	Public	001238

### INTRODUCTION

2003 NOV 12 AM 9:45  
M.O.A.  
70110 001238